

# Durably Energy Saving High Durability Caster 640S

The durability of swiveling is dramatically improved by a thrust bearing adapted to the swivel section, providing solid support for heavy-duty use cases, including AGVs and AMRs.



**640S-NRB75**

List of Products



Viewable  
JP / EN / CN

## Swivel durability improved to over 10X.

The load capacity is increased by adapting a thrust bearing that receives the load vertically with steel balls, which also improves swivel durability.

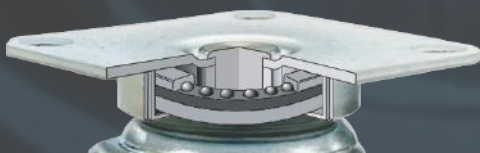

## Swivel starting force cut down to 50%.

Reducing the drive energy by lighter swivel starting force improves the operational efficiency of AGVs and AMRs.



**NEW**

**Swivel durability improved to over 10X.**

Performed repetitive swivel movements on a 450mm diameter circle while a weight is loaded on three casters.

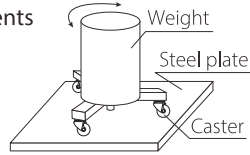

Test sample	Swivel durability test			Total Load : 600daN (200daN per caster)
	50,000 times	100,000 times	1,000,000 times	
Existing product	No concerns	Test stopped due to swivel failure	-	
<b>640S (NRB)</b>	<b>No concerns</b>	<b>No concerns</b>	<b>No concerns</b>	

**Swivel starting force cut down to 50%.**

Four casters are mounted on the testing machine, a load is loaded on them and the tensile force is measured from the push-pull.

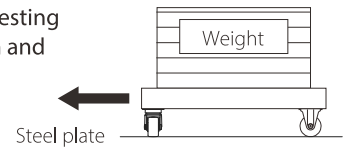

Test sample	Swivel starting force		Resistance coefficient
	300daN	500daN	
Existing product	4.38	7.96	0.0153
<b>640S (NRB)</b>	<b>1.98</b>	<b>3.47</b>	<b>0.0068</b>

**High Durability Caster 640S 50/65/75mm** **RoHS**

**Swivel**

**640S**

Swivel type  
Body : Unichrome coated



640S-NRB75

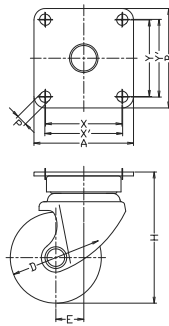

**Swivel**

**640 1S**

Swivel type  
Body : Unichrome coated



640 1S-NRB75

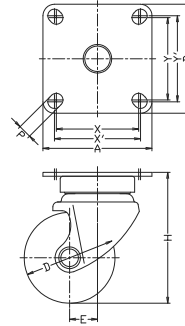

Scan below QR code to view our instruction video.



Caster type	Product code			Load Capacity 1pc(daN)	Overall height	Top plate	Fitting Pitch	Fastening hole dia.	Offset	Seivel radius
	Model No.	Wheel	Size (mm)		H mm	AxB mm	XxY(X'xY') mm	P mm	E mm	mm
<b>Swivel</b>	<b>640 S</b>	-	<input type="checkbox"/> <b>50</b>	<b>320</b>	88	82x82	63x63 (64x64)	8.8	20	48
<b>Swivel</b>	<b>640 S</b>	-	<input type="checkbox"/> <b>65</b>	<b>320</b>	98	82x82	63x63 (64x64)	8.8	22	58
<b>Swivel</b>	<b>640 S</b>	-	<input type="checkbox"/> <b>75</b>	<b>320</b>	108	82x82	63x63 (64x64)	8.8	23	63
<b>Swivel</b>	<b>640 1S</b>	-	<input type="checkbox"/> <b>50</b>	<b>320</b>	88	90x90	68x68 (71x71)	11	20	48
<b>Swivel</b>	<b>640 1S</b>	-	<input type="checkbox"/> <b>65</b>	<b>320</b>	98	90x90	68x68 (71x71)	11	22	58
<b>Swivel</b>	<b>640 1S</b>	-	<input type="checkbox"/> <b>75</b>	<b>320</b>	108	90x90	68x68 (71x71)	11	23	63

**Wheels** Please specify your wheel type from below.

**NRB**



**Nylon**  
solid type  
double ball bearing

**BAU**



**Urethane (thermosetting)**  
aluminum hub  
ball bearing

**PB**



**Phenolic**  
solid type  
roller bearing

Please consult our sale offices below for more details.



● Manufacturing Factory

**Headquarters factory**  
4-7-35, Nishi-Iwata, Higashi-Osaka, Osaka 578-0947 Japan  
**Hirakata factory**  
3-2-1, Shodaidajika, Hirakata, Osaka 573-1132 Japan

**HAMMER CASTER SALES**

● Hammer Caster Sales Co., Ltd. (as Sales company)

**Tokyo Branch**  
6-5-4, Shimbashi, Minato-ku, Tokyo 105-0004 Japan  
**Osaka Branch**  
1-2-6, Aramoto, Higashi-Osaka, Osaka 577-0023 Japan

23.07 HC · SP

■ Please feel free to ask for any caster consultancy.

E-mail : info@hammer-caster.co.jp  
Web : www.hammer-caster.com

■ Click and follow our official SNS accounts.



www.facebook.com/hammercasterofficial/



www.instagram.com/hammer\_caster\_official/